



Features :

- Constant voltage mode power supply
- 200-240Vac input only
- Fully encapsulated with IP67 level
- Protections: Short circuit/Over Voltage
- Small and compact size
- Class 2 power unit
- 100% full load burn-in test
- Suitable for LED lighting and moving sign applications
- 2 years warranty

SPECIFICATION:

MODEL		LV18-12	LV18-24
OUTPUT	DC VOLTAGE	12V	24V
	RATED CURRENT	1.5A	0.75A
	CURRENT RANGE	0 ~ 2A	0 ~ 1A
	RATED POWER	18W	18W
	RIPPLE & NOISE (max.)	150mVp-p	200mVp-p
	VOLTAGE TOLERANCE	±3.0%	
	LINE REGULATION	±1.0%	
	LOAD REGULATION	±2.0%	
	SETUP,RISE TIME	500ms,250ms/230VAC at full load	
	HOLD UP TIME (Typ.)	50ms/240VAC	
INPUT	VOLTAGE RANGE	200-240VAC	
	FREQUENCY RANGE	47 ~ 63Hz	
	EFFICIENCY (Typ.)	82% full load	84% full load
	AC CURRENT(at full load)	0.35A/240AC	
	INRUSH CURRENT (max.)	COLD STAT 40A/240VAC	
	LEAKAGE CURRENT	0.25mA/240VAC	
PROTECTION	SHORT CIRCUIT	Hiccup mode, recovers automatically after fault condition is removed.	
	OVER VOLTAGE	Above 13-20V	Above 25-36V
ENVIRONMENT	WORKING TEMP.	-10 ~ 50°C	
	WORKING HUMIDITY	18 ~ 90% RH non-condensing	
	STORAGE TEMP., HUMIDITY	-40 ~ 80°C, 10 ~ 95% RH	
	TEMP.COEFFICIENT	±0.03%/°C (0 ~ 50°C)	
	VIBRATION	10 ~ 500Hz, 2G 10min./1cycle, period for 60min. each along X,Y, Z axes	
SAFETY & EMC	SAFETY STANDARDS	Design refer to UL1310 Class 2,TUVEN62368-1, EN61347-2-13, CAN/CSAC22.2 No. 223-M91, meet IP67	
	WITHSTAND VOLTAGE	I/P-O/P:3KVAC	
	ISOLATION RESISTANCE	I/P-O/P:>100M Ohms / 500VDC / 25 ~ 70% RH	
	EMI CONDUCTION & RADIATION	Compliance to EN55032:2015+A11:2020	
DIMENSION		130*25*21mm (L*W*H)	

Mechanical Specification

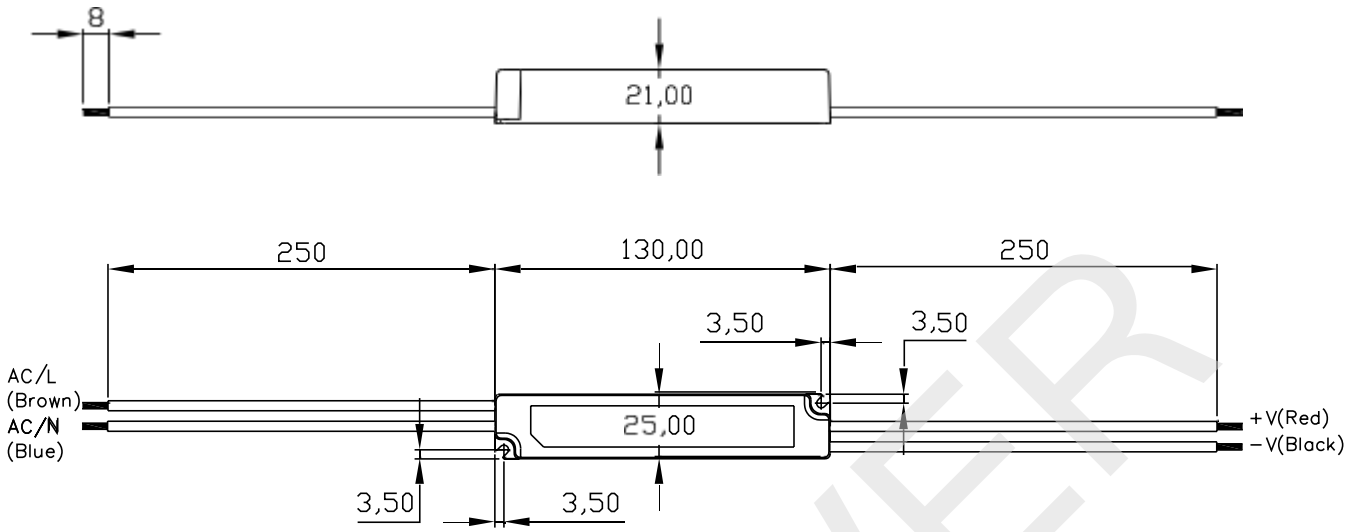

Block Diagram

